

# OPT-WT-35

MATERIAL. SEE BOM

FINISH. See Note for Individual Items

COLOR.

ITEM	PART NO.	QTY.	DESCRIPTION
1	731-1871	1	ASSY, TOP PLT, 18 HOLE, 10KG
2	731-0713	18	ASSY, WGT PLT, 10Kg, 25mm
3	731-0967	1	WEIGHT, TOP PLATE, ADD-ON, 16LBS

REVISIONS				
ECO	REVISION	REV DESCRIPTION	APPROVED	DATE
031215-A	A	INITIAL RELEASE TO IV PURCHASING	BTB	3/23/2015
072016-C	B	731-7501 and 731-7509 to replace 731-5644 and 731-0376	RCA	7/21/2016

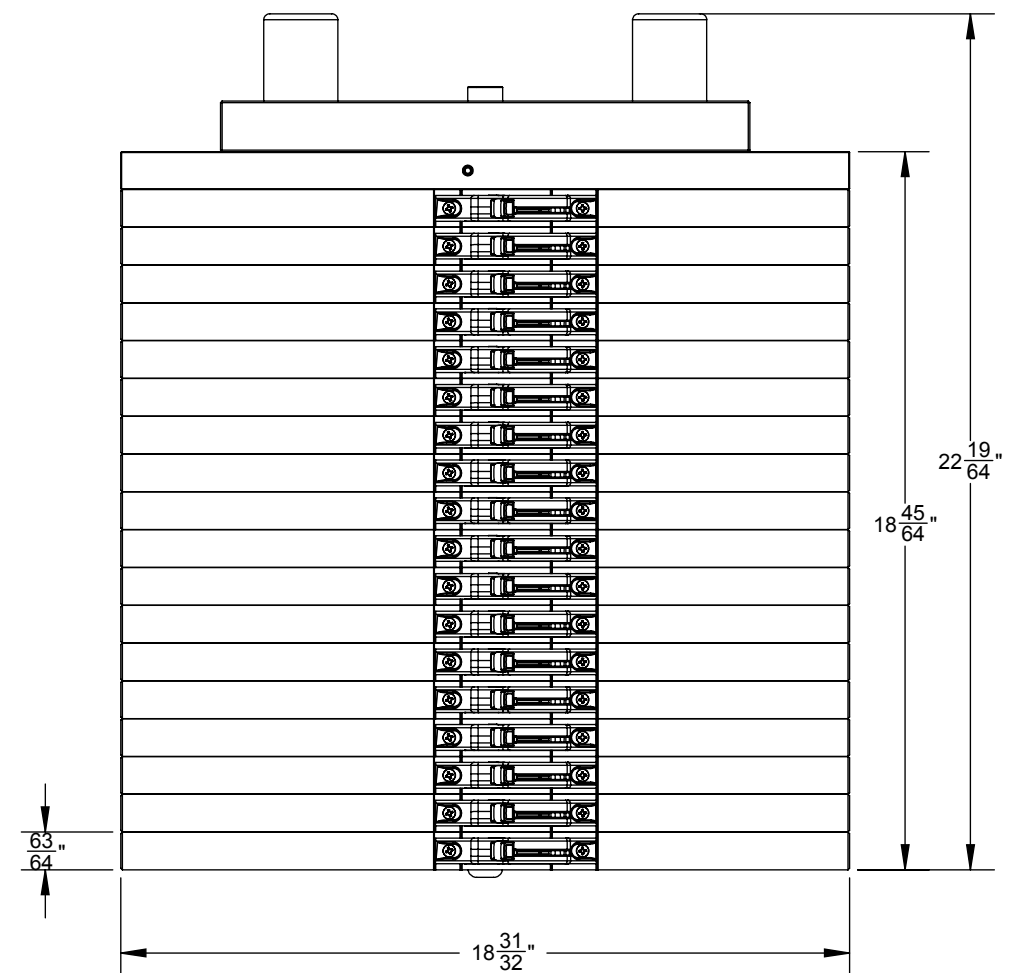
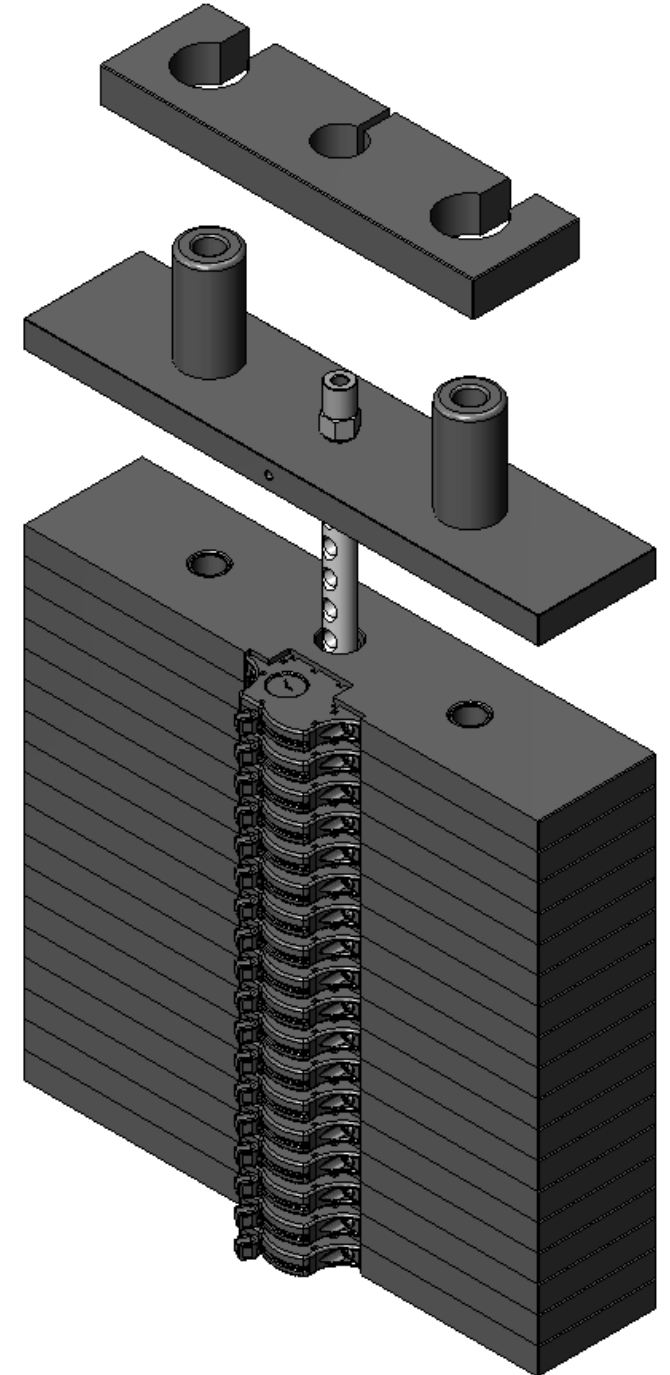
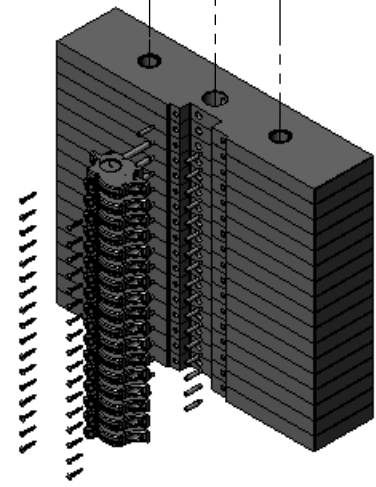
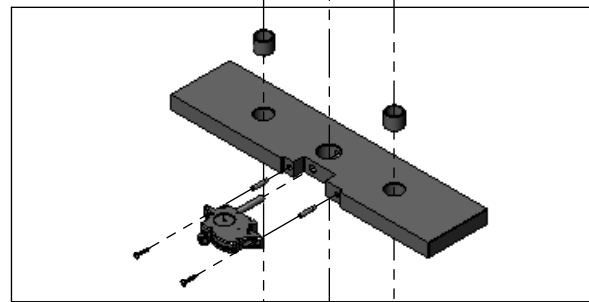
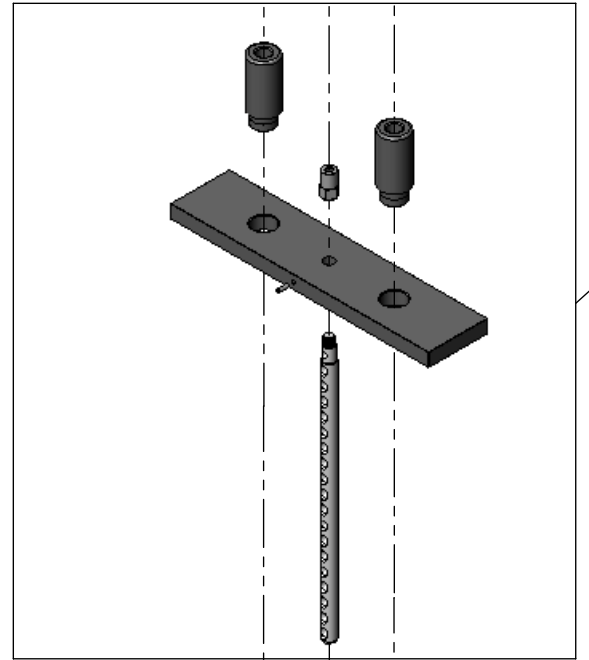
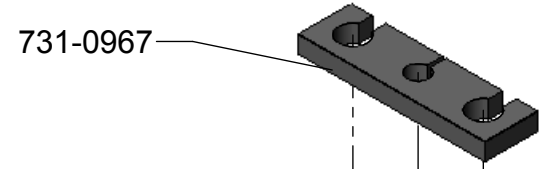

**WEIGHT KIT USED ON:  
1 - IPDA2**

	TOLERANCES UNLESS OTHERWISE SPECIFIED: ASME Y14.5M - 2009		DO NOT SCALE DRAWING		<b>TITLE:</b> ASSY, WGT STK, IPDA2, RIGHT TOWER <b>PART NO:</b> OPT-WT-35 <b>REV.</b> B
	<b>METRIC</b> X ± 3 XX ± 0.5 XXX ± 0.25 XXXX ± 0.1	<b>INCH</b> X ± .120 XX ± 0.020 XXX ± 0.010 XXXX ± 0.005 XIX ± 1/64"	DESIGNED: B. Ball DRAWN BY: B. Ball DATE: 3/23/15	PROJECTION: THIRD ANGLE ANGULAR TOLERANCE: ± 1°	
UNLESS OTHERWISE SPECIFIED: REMOVE ALL BURRS. BREAK SHARP EDGES (0.020 IN MAX) SURFACE FINISH: 32/125 Ra M SERIES CLASS: 8H/9g THREADS UNIFIED (UN) - CLASS: 2A/2B					

Core Health and Fitness, LLC  
709 Powerhouse Road, Independence, VA 24348  
This document is the property of Core Health and Fitness, LLC. It may not be reproduced in whole or part, provided to third parties, or used for any purposes other than the performance of work for Core Health and Fitness, LLC, without written authorization. All rights are reserved, including copyrights. SCALE: 1:5 SHEET 1 OF 4 INCH\_A\_REV A

# OPT-WT-35

MATERIAL. SEE BOM

FINISH. See Note for Individual Items

COLOR.

731-1871

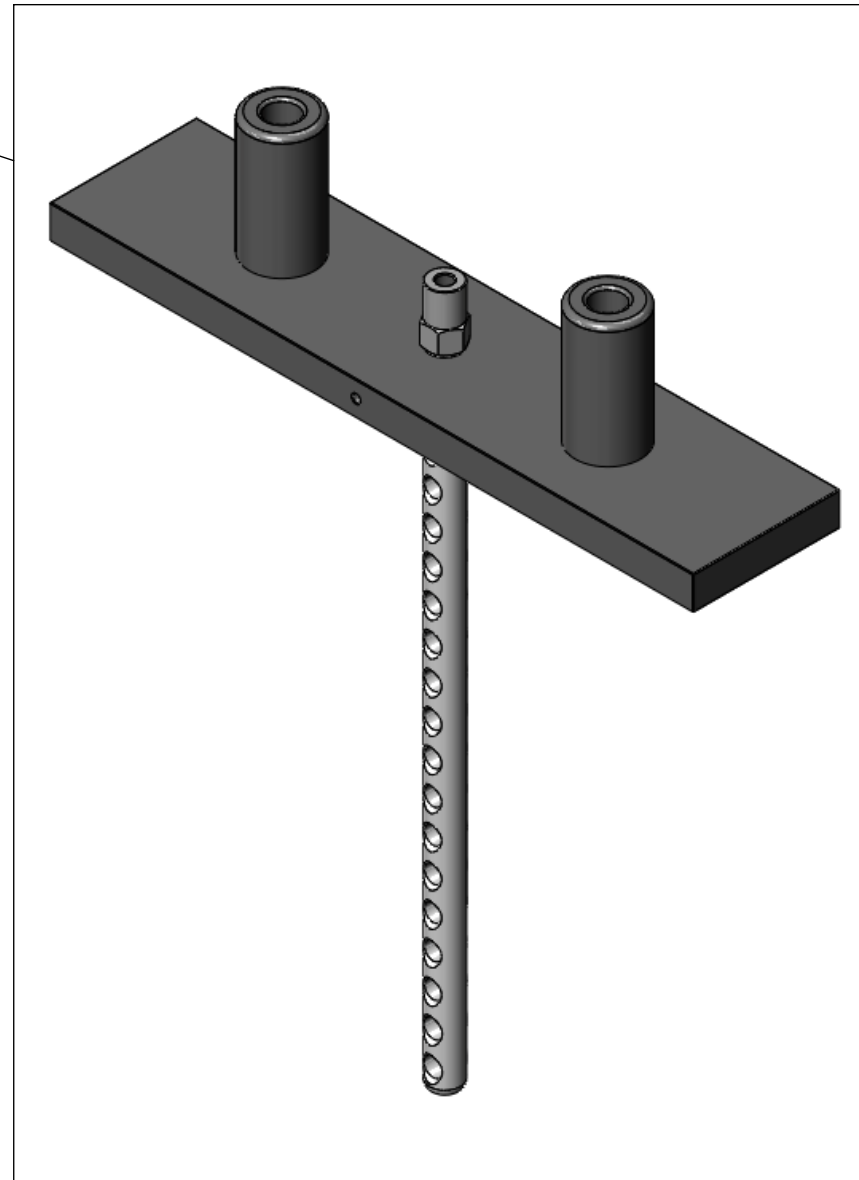

731-0110

731-1869

731-0110

731-1874

731-0382

731-1870

Number	QTY.	DESCRIPTION
731-0110	2	BUSHING, TOP PLATE, GUIDE RODE
731-0382	1	ROLL PIN, M6 X 20mm
731-1869	1	MOUNT, PULLEY, TOP PLATE
731-1870	1	POST, CENTER, TOP PLT, 18 X 25MM HOLE
731-1874	1	PLATE, TOP, 25mm, BLANK



TOLERANCES UNLESS OTHERWISE SPECIFIED: ASME Y14.5M - 2009				DO NOT SCALE DRAWING	
METRIC	X	± 3	X	± .120	 PROJECTION: THIRD ANGLE
	XX	± 0.5	XX	± 0.020	
	XXX	± 0.25	XXX	± 0.010	
	XXXX	± 0.1	XXX	± 0.005	
					DESIGNED: B. Ball DRAWN BY: B. Ball DATE: 3/23/15

TITLE: <b>ASSY, WGT STK, IPDA2, RIGHT TOWER</b>		REV. <b>B</b>
SIZE <b>B</b>	PART NO. <b>OPT-WT-35</b>	

# OPT-WT-35

MATERIAL. SEE BOM

FINISH. See Note for Individual Items

COLOR.

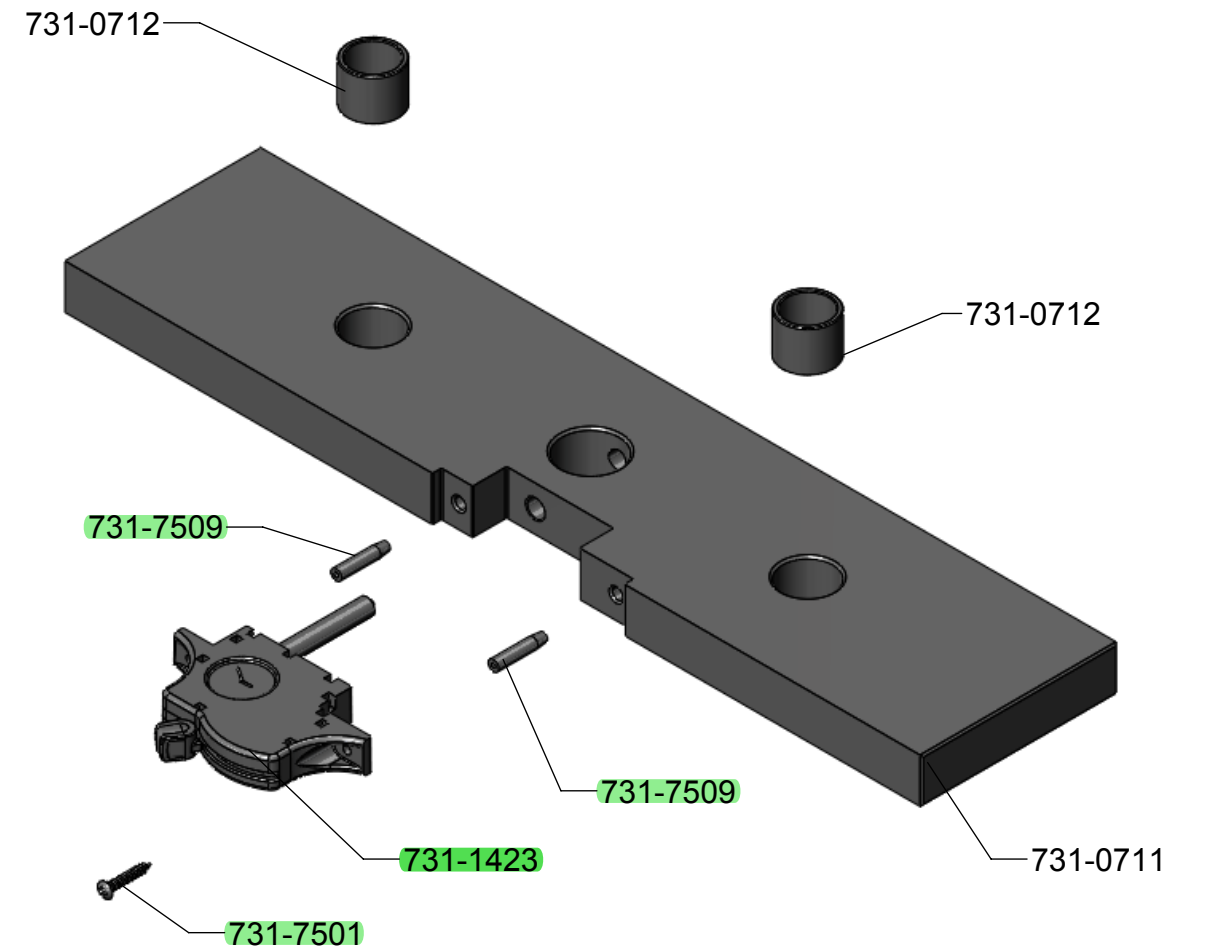
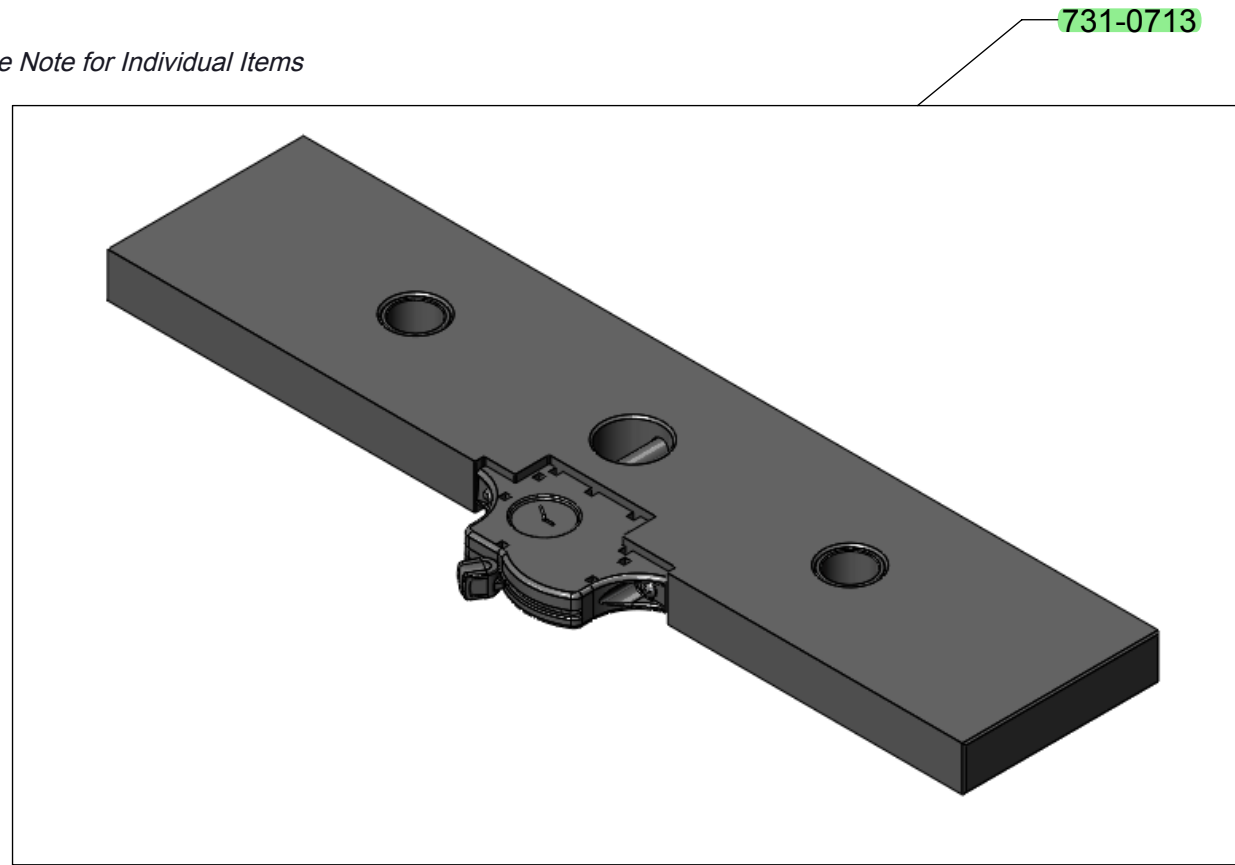

Number	QTY.	DESCRIPTION
731-7509	2	MOLLY, M6X28,LNL
731-0711	1	PLATE,WEIGHT,10Kg,25mm
731-0712	2	BUSHING,WGT PLT,10kg
731-1423	1	ASSY,SWITCH,LNL,STRAIGHT
731-7501	2	SCREW ,PHILLIPS, M4.2 X 25mm, SHEET METAL, PH, SS,FT



TOLERANCES UNLESS OTHERWISE SPECIFIED: ASME Y14.5M - 2009				DO NOT SCALE DRAWING	
METRIC	X	± 3	INCH	X	± .120
	XX	± 0.5		XX	± 0.020
	XXX	± 0.25		XXX	± 0.010
	XXXX	± 0.1		XXX	± 0.005
			XX	± 1/64"	
UNLESS OTHERWISE SPECIFIED: REMOVE ALL BURRS. BREAK SHARP EDGES (0.20 IN MAX)				PROJECTION: THIRD ANGLE	
SURFACE FINISH: 32/125				ANGULAR TOLERANCE: ± 1°	
M SERIES CLASS: 8H/8g				DATE: 3/23/15	
THREADS UNIFIED (UN) - CLASS: 2A/2B				SIZE B	

TITLE: <b>ASSY,WGT STK, IPDA2, RIGHT TOWER</b>		REV. <b>B</b>
PART NO. <b>OPT-WT-35</b>		
SCALE: 1:3	SHEET 3 OF 4	INCH_A_REV A

This document is the property of Core Health and Fitness, LLC. It may not be reproduced in whole or part, provided to third parties, or used for any purposes other than the performance of work for Core Health and Fitness, LLC, without written authorization. All rights are reserved, including copyrights.

# OPT-WT-35

MATERIAL. SEE BOM

FINISH. See Note for Individual Items

COLOR.

Number	QTY.	DESCRIPTION
731-1423	1	SPRING, LOCK N LOAD, STRAIGHT SWITCH
731-7501	2	SCREW ,PHILLIPS, M4.2 X 25mm, SHEET METAL, PH, SS, FT
731-7509	2	MOLLY, M6X28,LNL

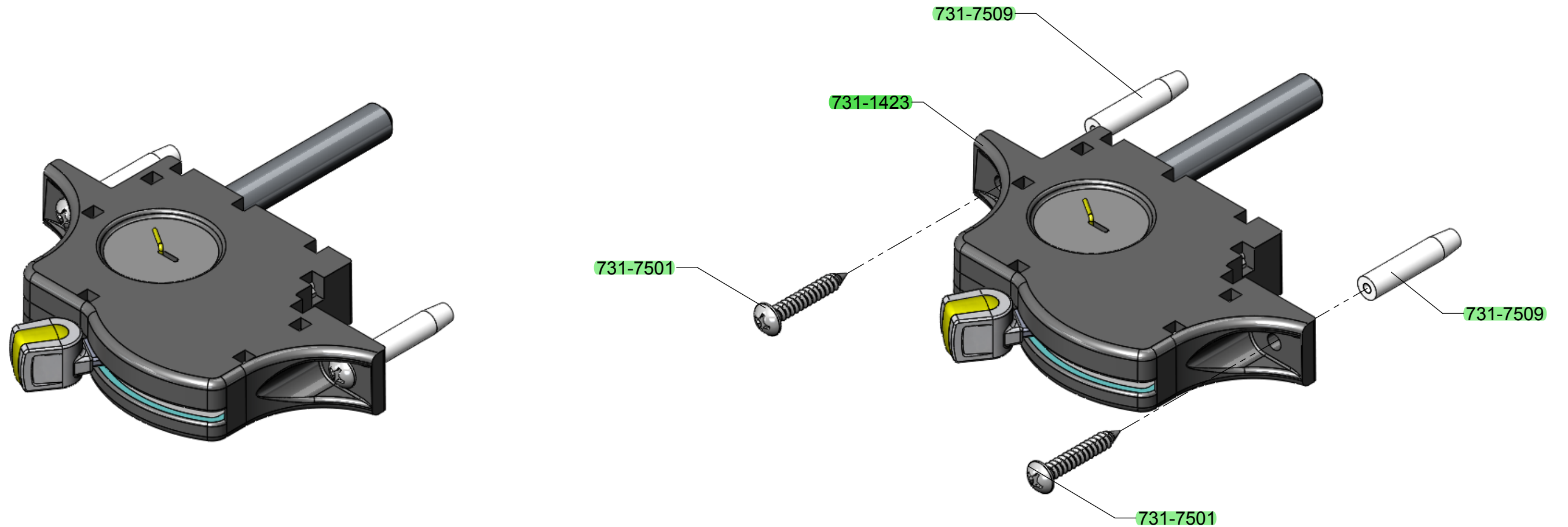

TOLERANCES UNLESS OTHERWISE SPECIFIED: ASME Y14.5M - 2009				DO NOT SCALE DRAWING	
METRIC	X	± 3	INCH	X	± .120
	XX	± 0.5		XX	± 0.020
	XXX	± 0.25		XXX	± 0.010
	XXXX	± 0.1		XXX	± 0.005
				XX	± 1/64"
UNLESS OTHERWISE SPECIFIED: REMOVE ALL BURRS. BREAK SHARP EDGES (0.020 IN MAX)				PROJECTION: THIRD ANGLE	
SURFACE FINISH: 32/125				ANGULAR TOLERANCE: ± 1°	
M SERIES CLASS: 8H/8g				DATE: 3/23/15	
THREADS UNIFIED (UN) - CLASS: 2A/2B				SIZE: B	

DESIGNED: B. Ball	TITLE: <b>ASSY, WGT STK, IPDA2, RIGHT TOWER</b>	REV. <b>B</b>
DRAWN BY: B. Ball		
DATE: 3/23/15	PART NO. <b>OPT-WT-35</b>	
SCALE: 1:1	SHEET 4 OF 4	INCH_A_REV A